

△ SPECIFICATION

Current Rating: 3 Amps/Contact Max.
 Contact Resistance: 4 Milliohms Max./Contact
 Insulation Resistance: 1000 Megohms Min. At 100V
 Operating Voltage: 60V AC/DC
 Average Insertion Force With Steel Pin Of $\phi 0.43\text{mm}$: <75g
 Average Withdrawal Force With Steel Pin Of $\phi 0.43\text{mm}$: >25g Min.
 Mechanical Life Cycle: 200 Min.
 Operating Temperature: Gold Plated: $-55^{\circ}\text{C}\sim+105^{\circ}\text{C}$
 Tin Plated: $-40^{\circ}\text{C}\sim+105^{\circ}\text{C}$
 Soldering Temperature: $+260^{\circ}\text{C}$, 10s Max.
 Pin(Outer Sleeve): Brass, Machined CuZn38Pb2,
 Tin Plated Over Nickel
 Clip(Contact 6 Finger): Beryllium Copper, Heat Treated,
 Gold Plated Over Nickel
 Insulator: PPS(UL94V-0), Black
 RoHS Compliant

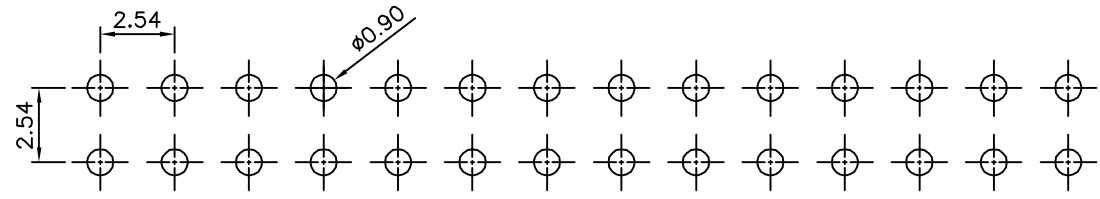

△ Recommended P.C.B. Layout

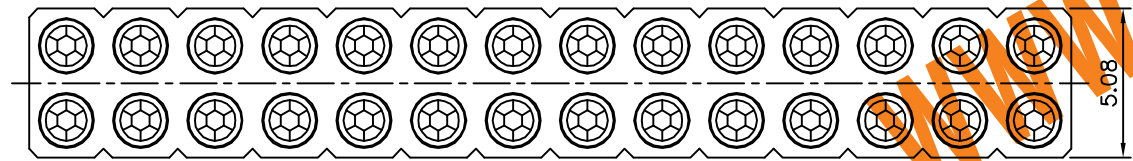

△

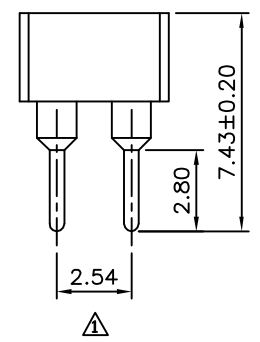
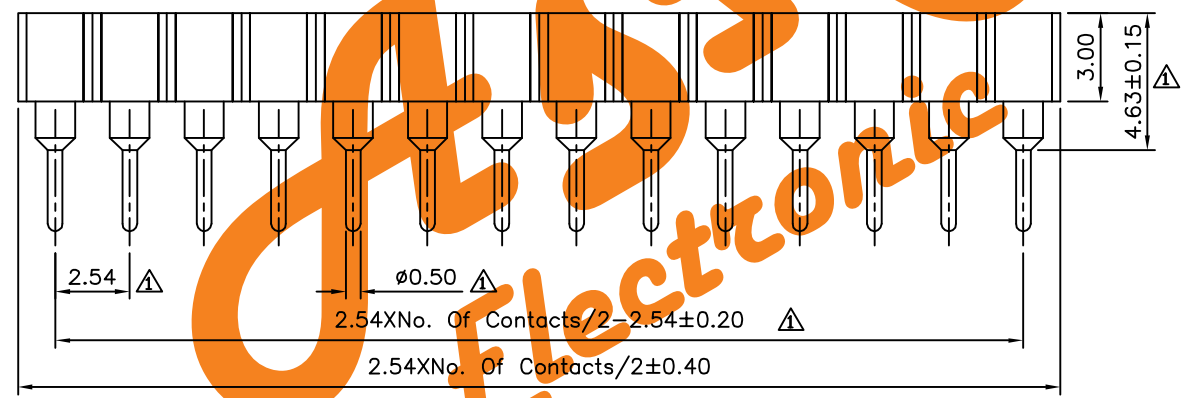

AsA Electronic
 WWW.Asa-Elec.com
 AsA Electronic Co.
 Tel : (+98) 21 66 73 56 82 Mob : (+98) 912 03 161 02

DRAWING No.		APPROVED BY MEI		UNLESS OTHERWISE SPECIFIED TOLERANCES ARE △ X ±0.50 X ±0.30 XX ±0.20 .XXX ±0.10 ANG. ±5°
		CHECKED BY H.Z		
		DRAWING BY SONG		
SCALE	NONE	REV.	A1	UNIT mm

NO.	REV.	REVISIONS	CHK	DATE
△ A1		Modify Data	HZF	08/23/2011
△ A0		NEW RELEASE	BECKY	12/22/2005